



MusiQ Instruction Manual
MusiQ Mode d'emploi
MusiQ Bedienungsanleitung



DECLARATION OF CONFORMITY, SAFETY

DECLARATION OF CONFORMITY

All MusiQ models have been designed and independently tested to be in compliance with the following standards:

Safety - EN60065:1993/IEC65, EMC-EN55013:1990, EN50082-1:1997, EN61000-3-2:1995, EN61000-3-3:1995

SAFETY



This symbol is to alert the user to the presence of dangerous voltages inside the MusiQ enclosure. To reduce the risk of electric shock do not remove any parts of the MusiQ.



This symbol is to alert the user to important operating instructions in the owner's information accompanying the MusiQ.

Read all the instructions before connecting or operating the MusiQ. Pay particular attention to the safety information. Keep this manual so you can refer to these safety instructions.

WARNING:

There are no user serviceable parts inside. Refer all servicing to qualified service personnel.

WARNING:

To reduce the risk of fire or electric shock, do not expose the MusiQ to moisture or water. Do not allow foreign objects to get into the enclosure. If the unit is exposed to moisture, or a foreign object gets into the enclosure, immediately disconnect the power cord from the wall. Take the unit to a qualified service person for inspection and necessary repairs.

The RFS MusiQ product must only be used with the supplied aerial. The aerial must not be attached via an extension cable. Under no circumstances should the MusiQ be connected to any other receiving system.

Installation of the KMM Keypad/Display and the RF Docking Handset should only be carried out by a competent person with reasonable DIY knowledge or a professional builder/Installer.

Clean the MusiQ only with a dry cloth or a vacuum cleaner.

Place the MusiQ on a fixed, level surface strong enough to support its weight. Keep the MusiQ away from radiators, heat registers, stoves, or any other appliance that produces heat.

If the MusiQ is placed in an enclosure, there must be sufficient ventilation of the enclosure to allow proper cooling.

Connect the MusiQ to the power outlet only with the supplied 3-pin grounded power supply cable or an exact equivalent. The cable should be connected to a properly grounded 3-pin wall outlet. Do not modify the supplied cable in any way. Do not use extension cords.

Do not route the power cord where it will be crushed, pinched, bent at severe angles, exposed to heat, or damaged in any way. If the cable shows any sign of wear or damage, immediately stop using it and obtain a proper replacement from a qualified service agency or from the QED service department.

If the MusiQ shows signs of improper operation, or if it has been dropped or damaged in any way, immediately disconnect the power cord from the wall. Take the MusiQ to a qualified service person for inspection and necessary repairs.

The MusiQ product should not be used in locations where it will be subjected to high levels of radiated R.F., or where its connecting cables will be subjected to high levels of R.F. interference from other sources.

GUARANTEE

All products are covered by a 2 year guarantee for parts and labour. Site visits are not covered by this guarantee and will normally result in a call out charge if such a visit is requested or deemed necessary.

CONTENTS

CONTENTS

		Page
Section 1:	INTRODUCTION AND DESCRIPTION	02
Section 2:	INSTALLATION	04
Section 3:	CONFIGURING THE SYSTEM	12
Section 4:	TROUBLESHOOTING	15
Section 5:	TECHNICAL SPECIFICATION	16
Section 6:	OPERATION	16
Section 7:	ADDITIONAL NOTES	20

1 INTRODUCTION

This manual is designed to enable you to install your MusiQ system, to configure it to meet your particular needs and to use the system as required.

1.1 OVERVIEW

MusiQ enables you to expand your Hi-Fi system into other areas of your home or commercial premises, and to control two of its sources remotely. Inside each MusiQ are two Stereo Pre-amplifiers and Power amplifiers that distribute sound from your main Hi-Fi sources, such as CD and tuner, to additional sets of loudspeakers.

A typical domestic MusiQ application would be to add suitable pairs of speakers in the kitchen and master bedroom. This would, for example, allow one person to listen to the radio in the kitchen while another listens to the CD player in the bedroom.

MusiQ allows you to select and control* the same or different sources at any time in each remote zone, and to have independent control over the volume level in each location.

MusiQ features high quality audio circuitry that is capable of giving excellent results with many types of loudspeakers.

** See System Features- Built-in Source Control*

1.2 MUSIQ VARIANTS

MusiQ is available in two model types: IS and RFS. Both models have the same basic functionality; the difference being in how each model is controlled and the way in which its status is displayed.

MusiQ IS - Control is via a wall mounted keypad (KMM Keypad/Sensor) in each remote room/zone. The keypad controls the MusiQ and, when applicable, the sensor function acts as a universal infra-red link to relay control commands to a source component from that unit's infra-red handset.

The MusiQ IS System includes Controller and two KMM Keypads



INTRODUCTION AND DESCRIPTION

MusiQ RFS - This model includes the front panel control option and in addition offers full remote control via a wireless RF (radio frequency) handset. Additionally, if the handset is mounted on a hard-wired docking station, the handset can be used as a universal infra-red link in the same way as the Keypad/Sensor to relay control commands to a source component from that unit's infra-red handset.

The RFS version is particularly suited as a retro-fit in domestic installations where speaker wires are already in place or can be easily routed. It can also be used for commercial applications requiring more flexible control.

The MusiQ RFS System includes Controller and two Docking RF Handsets.



1.3 SYSTEM FEATURES

Note: The following features are common to all MusiQ variants.

- **Two Stereo Source inputs** - These inputs will normally be from a Tuner and CD player. They can, however, be connected to any source which provides a line level output between 500 mV and 2.0 V rms.
- **Microphone input via a 3.5mm jack socket.** Announcements can be made over one or both Zones. For the best performance, an Electret Condenser type microphone is recommended with an impedance of approximately 600 ohms. Microphones featuring an on/off switch terminated in a 2.5 mm jack are particularly suitable as they will operate the microphone paging trigger.
- **Two remote keypad inputs** - The keypad socket enables remote control of each MusiQ zone via a wired link to a MusiQ KMM Keypad module. Also used if the RF Handset docking station is to be used for IR relay.
- **Four infra-red (window emitter) outputs via 3.5 mm jack sockets.** These outputs enable up to four sources to be controlled through MusiQ by re-transmitting IR control codes from remote zones (and from the unit's internal software), directly into the IR sensors of the source components.
- **SDB (Serial Data Bus connection)** - This allows multiple MusiQ units to be connected together, enabling larger installations to be constructed and controlled from a single point.
- **Active EQ Sound Enhancement** - Each Zone can be configured independently to enhance the sound image. This is particularly useful when using MusiQ with smaller loudspeakers that do not have a full frequency range.
- **Party Mode** - When you are having a party, MusiQ lets you control all zones from a single keypad. This feature is extremely useful in multiple MusiQ installations where you want to listen to the same source in all zones at a common volume level.
- **Built in source control** - Prime CD & Tuner control functions have been embedded into MusiQ for some of the most popular brands of Hi-Fi equipment (See Specification section for list of supported brands). This means that with a simple button press on the wall mounted keypad, control panel keypad or RF handset you can skip presets on the Tuner, start the CD player and even skip tracks and discs. No need to carry a second remote around the house!

2 INSTALLATION

2.1 Source Connection Options

There are essentially two different types of connection

2.2 Direct Connection of Hi-Fi Separates

This involves connecting the MusiQ directly to two pieces of source equipment such as a CD player and a Tuner (see diagram below). A loop through cable is provided to allow the sources to be shared with a normal Hi-Fi amplifier.

The Tuner should be connected to Input 1 and the CD should be connected to input 2. Connecting the sources up in this manner enables the loop through cable to be used as shown in the following diagram. Use standard shielded phono to phono cables to connect the sources to the appropriate inputs on the MusiQ. Ensure that care is taken to maintain channel continuity between the left and the right channels.

2.3 Connection of Mini & Micro Hi-Fi Systems

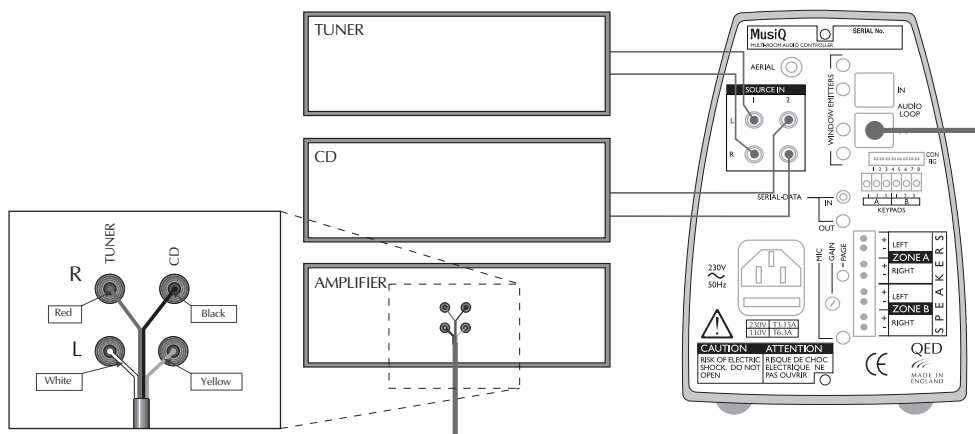

INSTALLATION

When using an integrated Hi-Fi system without individual source outputs, the recommended connection is to the “Line Out” sockets. These sockets are provided on many systems and may be labelled as “Aux Out” or “Tape out”. Most Mini & Micro systems route the currently selected source to these sockets, this enables MusiQ to distribute the sound from the main system into other areas with independent volume control. Many of these systems can be controlled remotely through MusiQ using their own handset. However, it should be noted that most Mini & Micro systems ‘enable’ only the last source to receive a command. This may be inconvenient if two listeners want to listen to different sources!

Connection to a Mini or Micro System

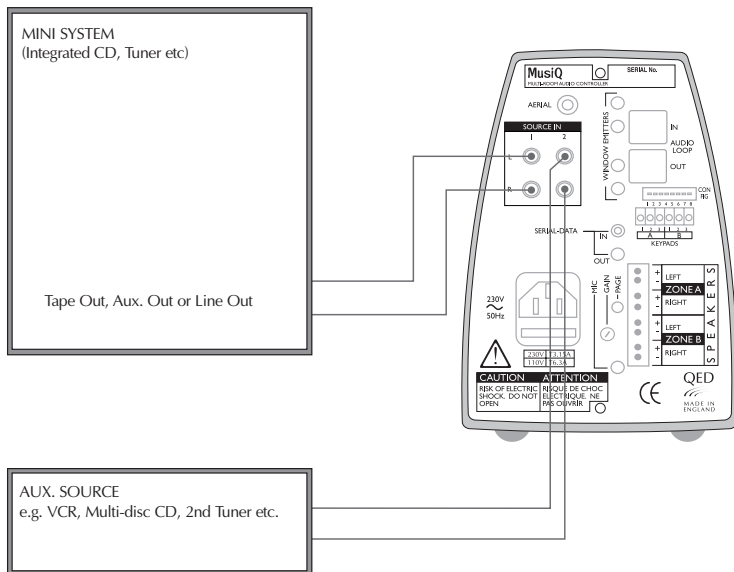

Connection to Hi-Fi Separates using the Amplifier's Tape Output

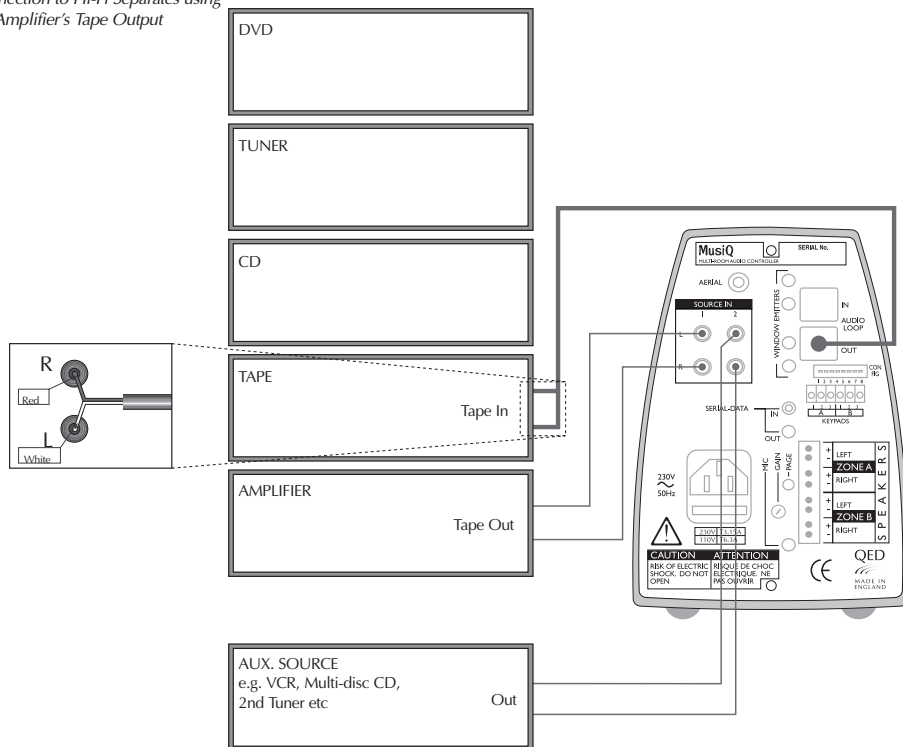

When connecting more than two source components it may be more convenient to use the Tape Output sockets from the main amplifier. This type of connection enables access to all source components by using the ‘Record Out’ signal. Whatever source is selected on the main amplifier will be routed through to the MusiQ for distribution. Some amplifiers have a separate record selector which enables the MusiQ to receive a different source to that being played by the main amplifier.

2.5 GENERAL INFORMATION

2.5.1 COMPONENT LOCATION

Locate MusiQ near to the components that you wish to connect. Ensure that adequate ventilation is allowed around the MusiQ case as this can become warm under use. When installing the MusiQ RFS ensure that both the unit and docking handset (if located on a wall) are positioned away from large metal objects such as filing cabinets. These can block the radio signal and reduce the effective control range of the RF Handset. In most installations RF reception should not be a problem, however you are advised to note the following warning:-

WARNING: IMPORTANT INFORMATION: Always check the operation of the RF handset before installing wires. Do this by temporarily connecting a music source and speakers to MusiQ, and then checking that you are able to operate the unit from all locations where you want control. If you are installing an RFS check that the RF receive symbol stays on continuously when a button is pressed on the RF Handset. Any flickering indicates poor reception. This test is particularly important before affixing the RF docking port.

2.5.2 EMBEDDED SOURCE CONTROL COMMANDS

To enable easy control of Tuner and CD source components the MusiQ has a number of prime control functions built into its software. This means, for example, that its possible to skip tuner stations or tracks on a CD without having to use a separate handset. The available control functions are detailed in Section 6.4.

For this feature to work correctly you need to ensure that the source components are compatible with the latest version of the MusiQ software. The supported brands/operating codes are as follows:

- **RC-5** - A Philips code set used by many other companies including Arcam, Linn and Marantz.

Caution: Some manufacturers who claim to use this code set do not follow the correct protocol and therefore their equipment may not respond correctly, or at all.

- **Denon** *Caution: MusiQ will operate tuners with direct preset selection only.*
- **Pioneer**
- **Sony**
- **Yamaha**

Please Note: Every effort has been made to ensure compatibility with the latest models of the above branded equipment. However, compatibility cannot be guaranteed. We strongly recommend that you confirm operation with the equipment you plan to use. If in doubt, consult with the Hi-Fi Dealer supplying the MusiQ product.

2.5.3 AERIAL CONNECTION (RFS Model only)

The Wireless Control System employed by the RFS Controller requires a special aerial to be fitted as shown.

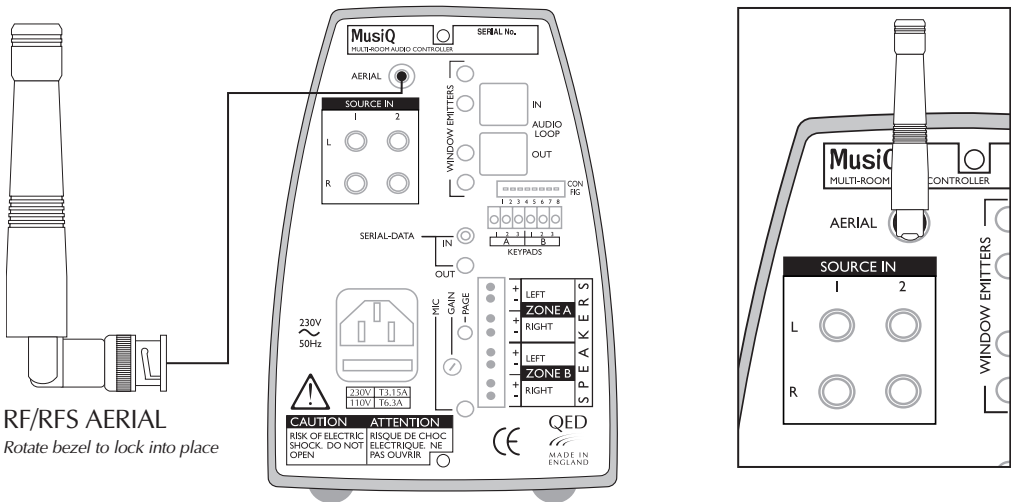

2.5.4 SPEAKER CONNECTIONS

Note: The recommended speaker impedance for use with MusiQ is 8 ohms.
The minimum impedance for use with MusiQ is 4 ohms.

Use the supplied quick-fit terminals for all speaker cable connections.

Strip back each conductor's outer insulation by 6mm, insert bare wire into quick fit plug and secure using the screw terminal fixing. Take care to ensure proper polarity (note "+" is normally identified by a fine rib running along one edge).

BE CAREFUL AND BE PATIENT. It is essential to have the speakers correctly connected for maximum system enjoyment.

"Out of phase" loudspeaker hookups (where one speaker in a stereo pair is inadvertently connected "+" to "-" and vice versa) may not be immediately noticeable but will not be as pleasing in the long term as a properly connected stereo pair.

Route speaker cables from each remote Zone to the rear of the MusiQ and connect as follows:

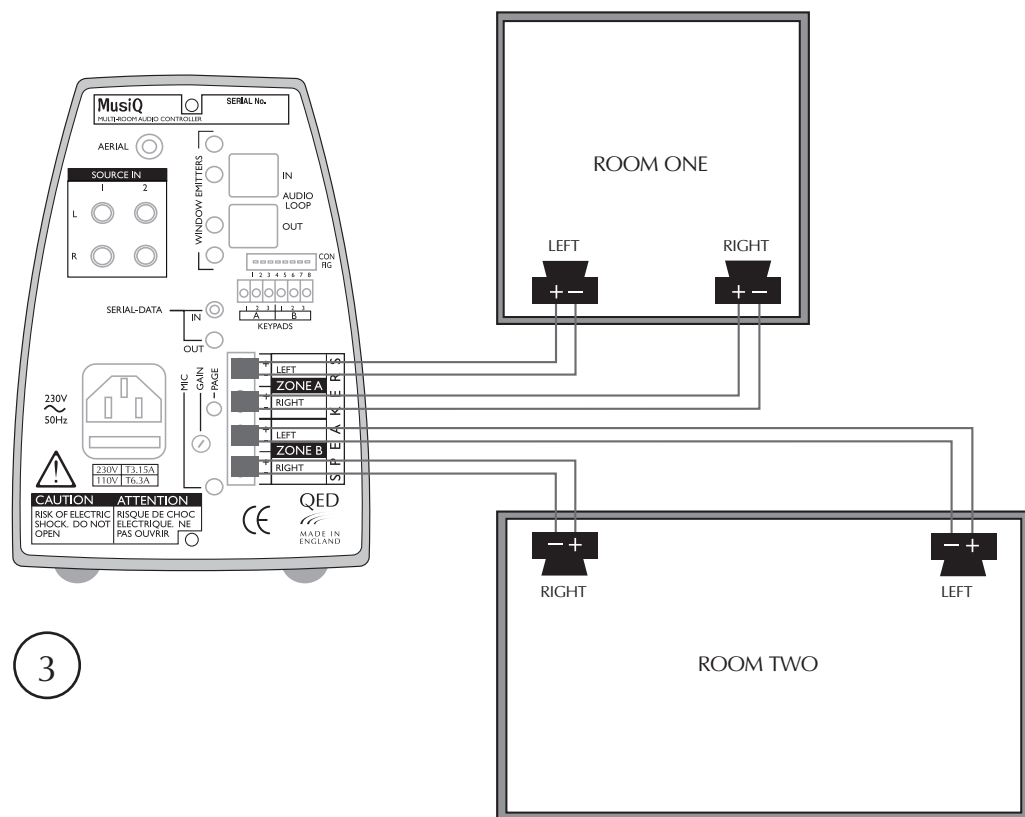
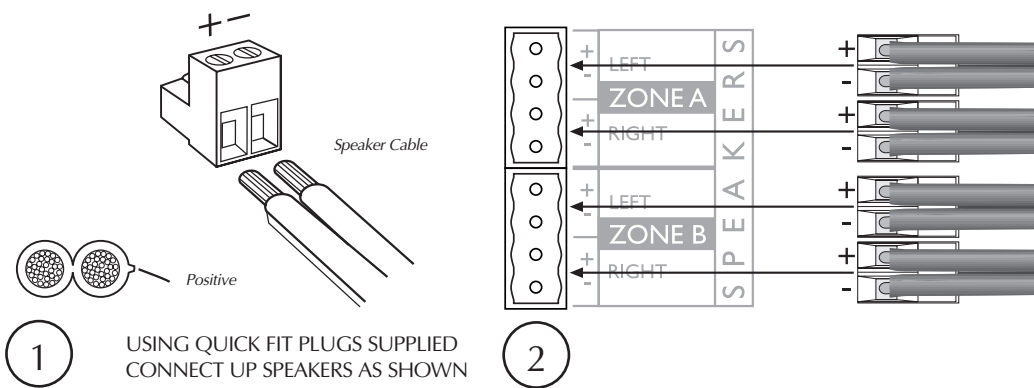

2.5.5 FITTING KMM MODULE INTO BACK BOX AND WALL PLATES.

- 1) Clip module into grey mounting frame, as shown.
- 2) Make all necessary wire connections to module.
- 3) Screw in to wall box.
- 4) Clip on System 45* fascia plate.

*System 45 and Sistema 45 are trade marks of Hamilton Ltd. England and Ave Spa Italy respectively. Alternative versions of mounting plates and facias are available to fit a wide variety of mainland European back-boxes including the round type - please ask your distributor for details.

A very wide variety of System 45 facias are available in numerous colours and finishes, ask your dealer for details.

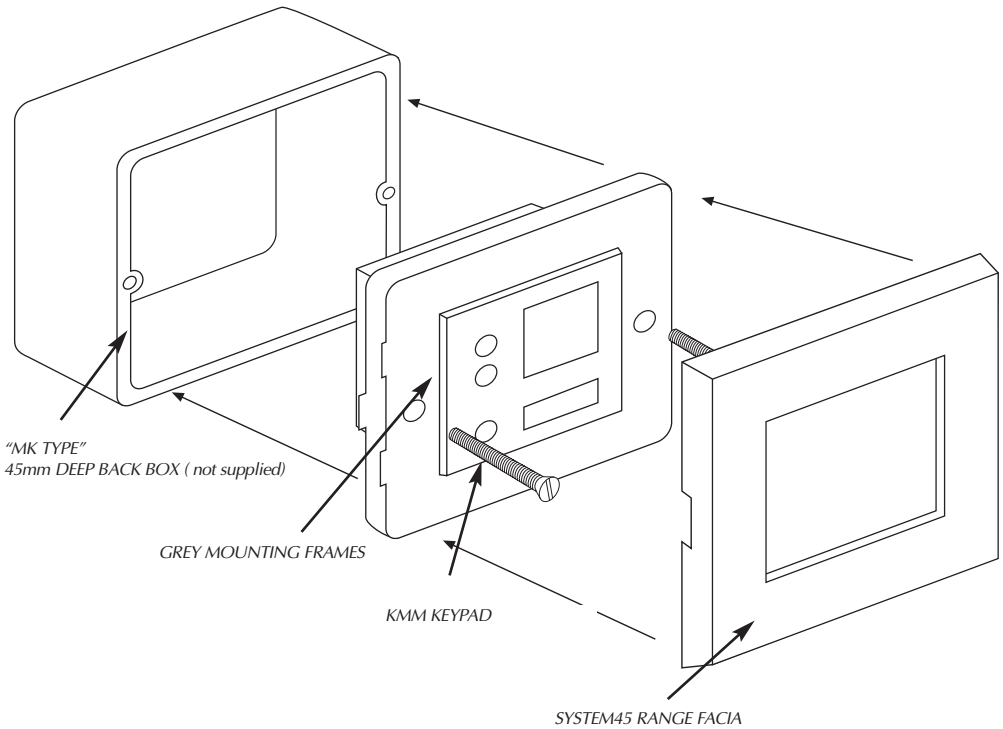

2.5.6 KMM KEYPAD/SENSOR CONNECTIONS

When using KMM Keypad/Sensors, route a three core cable (telephone cable is ideal for this purpose) from each remote Zone to the rear of the MusiQ and connect as follows (see diagram below).

Note: The 6-way connector plug that locates into the Keypad socket at the rear of the MusiQ is inserted UPSIDE DOWN (Screws facing downwards). Remember this when wiring the plug as the connections will be reversed when the plug is turned through 180°.

Do not take any notice of the 1 embossed on the 6-way connector plug.

Setting the KMM Keypad Module:

At the rear of each KMM Keypad you will see two small two-way switches at the rear of the unit.

To configure the Keypad to the correct Zone, set the switch as follows:

Keypad for Zone A - Switch 1 to OFF

Keypad for Zone B - Switch 1 to ON

To Enable or Disable display LEDs

Switch 2 is normally not used

ON - LED display active

OFF - LED display NOT active

Note: The purpose of this switch is to disable the LED display on the KMM when connecting to a MusiQ RFS. With these MusiQ controllers any control function issued from the front panel controls will not be reflected by the LED display on the KMM and hence the KMM will display incorrect information. In this case disable the LED display to avoid confusion.

The KMM is supplied with a choice of button caps to enable selection of the most appropriate input labelling. The buttons are '1' & '2' to match the front panel source controls of the RFS and also "Music", "Video", "CD" and "Tuner" symbols. The "Music" symbol is ideal for a MusiQ input that is connected to a Tape or Auxiliary Output.

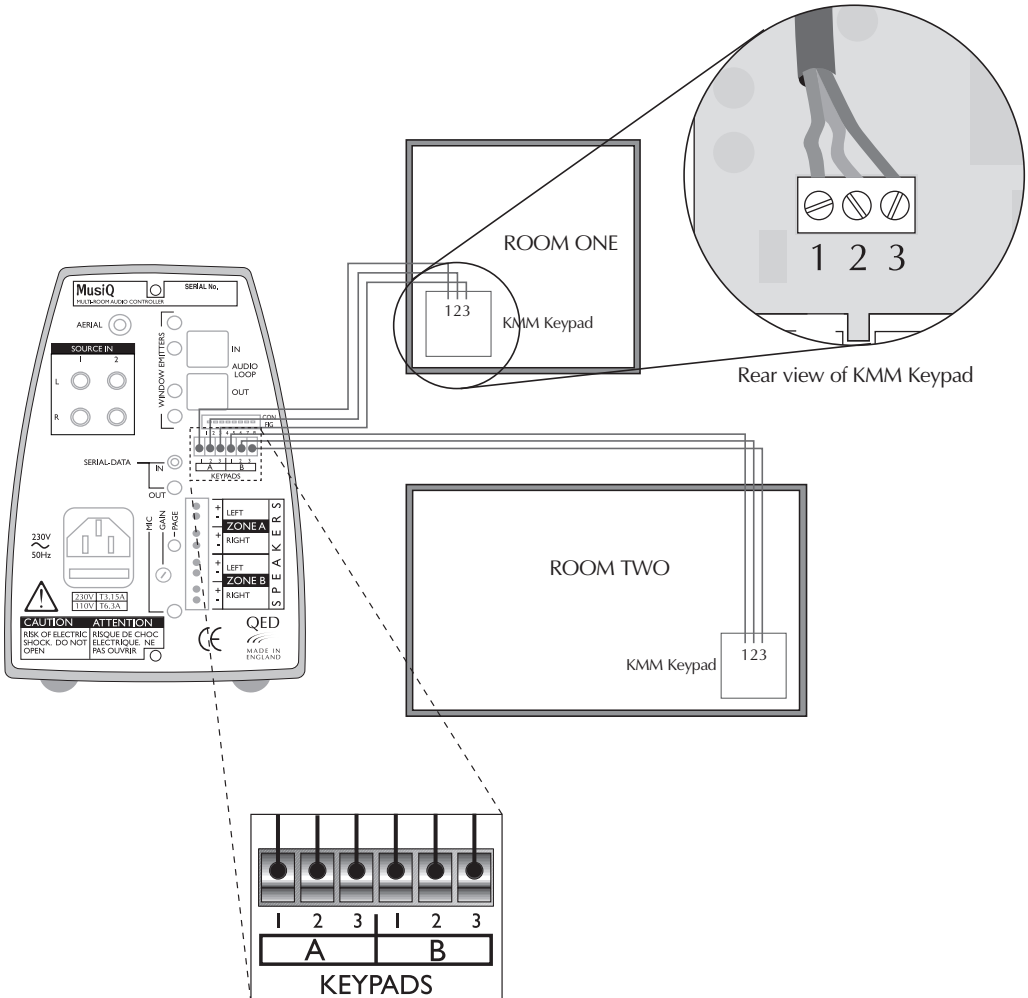

2.5.7 RF HANDSET DOCKING PORT

To use the infra-red relay feature of the RF handset, route a three core cable (telephone cable is ideal for this purpose) from each docking port to one of the Keypad sockets at the rear of the MusiQ. Connect as follows:

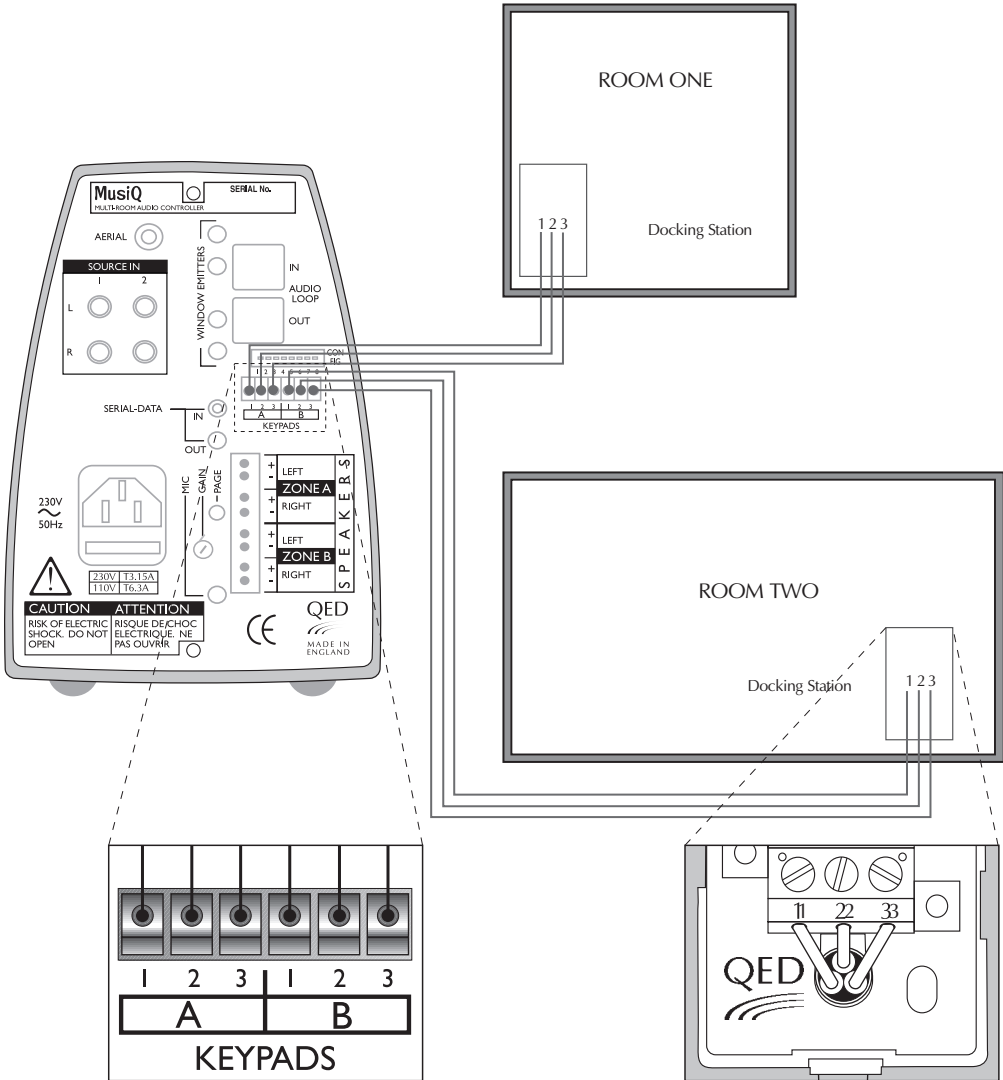

1

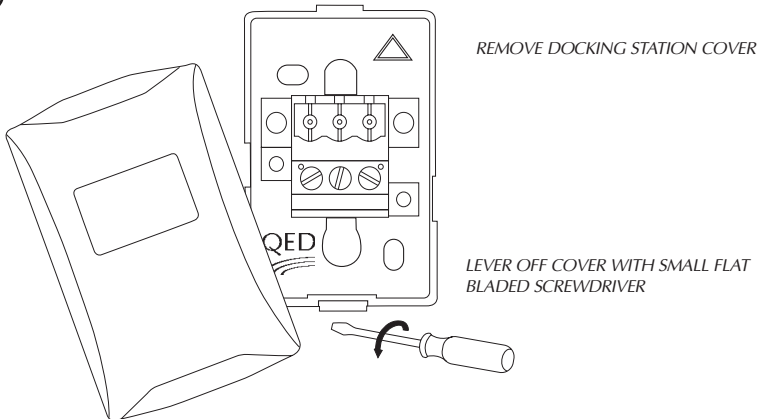

INSTALLATION

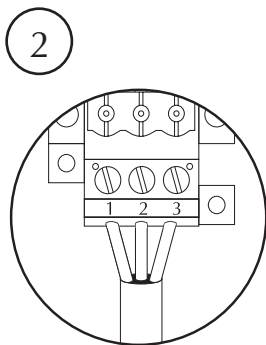

TERMINAL NUMBERING

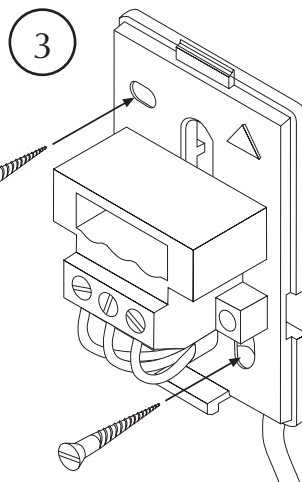
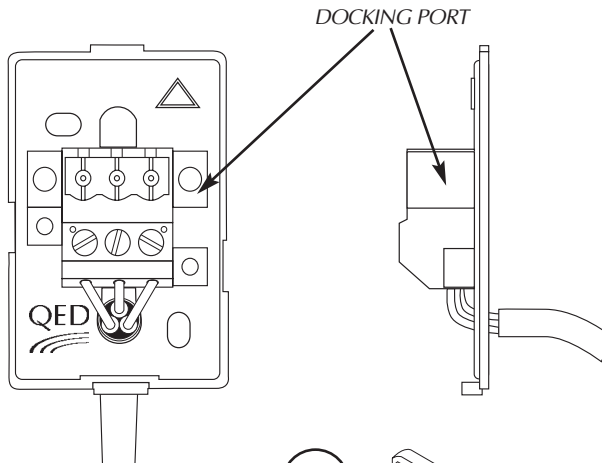

FIX TO WALL USING SCREWS SUPPLIED AND REPLACE COVER

- 1) Place the Docking Station back plate into the desired location and mark the hole positions.
- 2) Using a 5mm masonry drill bit, drill two holes 35mm deep at the marked positions.
- 3) Insert the rawl plugs flush to the wall surface.
- 4) Wire the connector as detailed in the above diagram.
- 5) Secure the back plate into position using the screws provided. Do not overtighten.
- 6) Affix the cover by locating the top edge and clipping the bottom into place.

2.6 CONNECTING A MICROPHONE

If using a microphone, ensure that it is fitted with a 3.5 mm jack plug. Insert the jack plug into the MIC socket at the back of the MusiQ. If the microphone also has a contact-switched (ON/OFF) 2.5 mm Jack, this should be inserted into the PAGE socket.

Note: ONLY Mono Microphones should be used.

Always ensure that plugs are fully inserted into their sockets.

If the MIC volume is too high, adjust the MIC Gain Control at the rear of the unit using a flat bladed screwdriver.

WARNING:

Ensure that the gain is not set too high. If any distortion is noticed when using the microphone then reduce the gain until the distortion is removed.

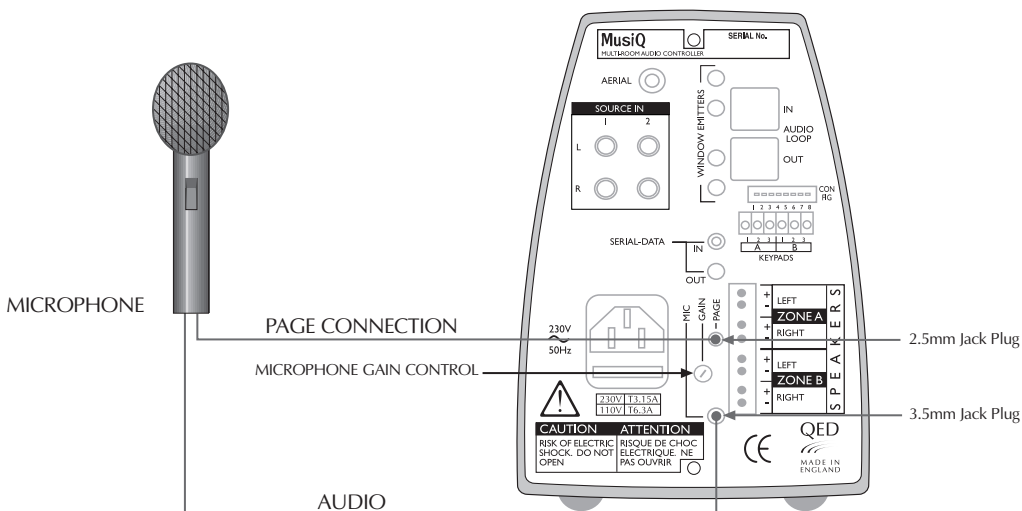

2.7 FITTING WINDOW EMITTERS

In order for the MusiQ to control the source equipment, either by the embedded functions or the I.R. Relay, Window Emitters must be fitted. Each Window Emitter has a lead approximately 1.5m long and is fitted into MusiQ by means of a 3.5mm Jack Plug. The small emitter LED fits to the front of the source component by means of a sticky pad. Correct positioning of the emitter should be checked before being attached, by sending codes through a KMM module or using the embedded control commands from the front panel or RF handset.

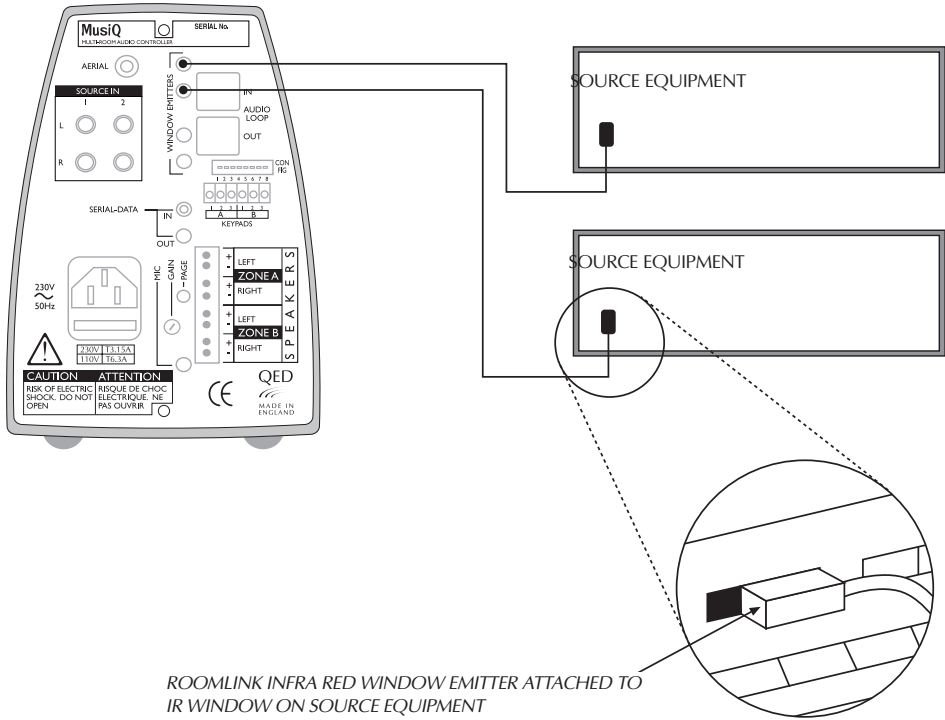

3 CONFIGURING THE SYSTEM

MusiQ will work straight out of its box, however there are a number of settings that can be adjusted by altering the CON FIG switches at the rear of MusiQ.

Note: It is particularly important to configure the address switches correctly when using more than one RFS MusiQ.

3.1 CONFIGURATION SWITCH SUMMARY

	Configuration Switch	Configuration Switch Up = ON	Configuration Switch Down = OFF
Switch No.1	Paging inhibit	Only Page Zone A	Paging Active in Zone A & B
Switch No.2	Active EQ sound Enhancement Zone A	Enhanced Bass & Treble	Flat Frequency Response
Switch No.3	Active EQ sound Enhancement Zone B	Enhanced Bass & Treble	Flat Frequency Response
Switch No.4	Master/Slave	MusiQ is Master	MusiQ is Slave unit
Switch No.5	Party Mode	Unit in Party Mode	Zone A & B work independently
Switch No.6	MusiQ Address 1 (Used only on RF model)		
Switch No.7	MusiQ Address 2 (Used only on RF model)		
Switch No.8	MusiQ Address 2 (Used only on RF model)		

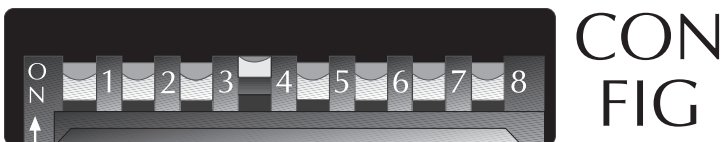

3.1.1 SWITCH 1 - PAGING INHIBIT

When using MusiQ with a microphone, you may only want the announcement to be broadcast over one zone. By setting the switch to ON, only Zone A will relay microphone announcements.

3.1.2 SWITCHES 2 AND 3 - ACTIVE EQ SOUND ENHANCEMENT

When using very small speaker systems or low cost ceiling speakers you should set the Active EQ sound enhancement feature ON in the appropriate Zone/s to give a fuller and more powerful sound. Experiment to decide which switch position gives the best results in your environment.

Note: When resetting the Active EQ sound enhancement switches you must turn the mains power Off and then On for the new settings to take effect.

3.1.3 SWITCH 4 - SLAVE OR MASTER

When using a single MusiQ switch 4 should always be set to Master (ON).

When using multiple MusiQs it is possible to control all units from a single keypad. To do this, switch 4 on all units other than the Prime MusiQ, must be set to Slave (OFF). This limits the units communication to the SDB Serial Data Bus only.

There are many different configuration options; refer to section 3.2 for further details.

Note: You can Mix RFS and IS units together if you wish. When constructing a large system where control is required from a central location, it is recommended that a Master RFS unit be used in conjunction with IS units set in Slave mode. This gives the most economical solution.

3.1.4 SWITCH 5 - PARTY MODE

MusiQ can be configured to operate Zone A and Zone B simultaneously from the RF handset, KMM Keypad or front panel control by setting switch 5 to ON. This means that if either a Zone A or Zone B command is issued both zones will respond, selecting the same source and volume level. This is particularly useful when you want the same sound in all zones. When party mode is selected, the standby LED will glow AMBER when both zones are in standby. To enter party mode on the RFS units depress both standby buttons simultaneously when both zones are in standby. If the unit is an RFS, the display will show a Party Cocktail glass when the unit is active. To exit party mode depress both standby buttons simultaneously when in standby.



3.2 CONFIGURING MULTIPLE MUSIQ RFS

When using the RFS version of MusiQ it is important that the address switches of both the MusiQ and RF handsets are set to the same settings. When using more than one MusiQ RFS, it is advisable to set each MusiQ to a different address.

The factory defaults will enable the use of one MusiQ RFS without the need to change the address switch settings on the MusiQ or RF Handsets. If more than one MusiQ RFS is being used, you are advised to follow the table below:

RFS CONTROLLER ADDRESS SWITCHES

MUSIQ			
	Switch 6	Switch 7	Switch 8
MusiQ 1	OFF	OFF	OFF
MusiQ 2	OFF	OFF	ON
MusiQ 3	OFF	ON	OFF
MusiQ 4	OFF	ON	ON
MusiQ 5	ON	OFF	OFF
MusiQ 6	ON	OFF	ON
MusiQ 7	ON	ON	OFF
MusiQ 8	ON	ON	ON

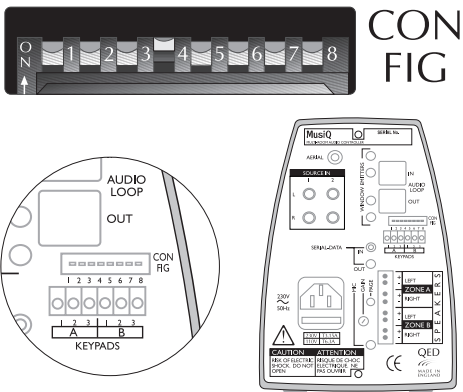

RF HANDSET ADDRESS SWITCHES

HANDSET				
	Switch 1 A/B	Switch 2	Switch 3	Switch 4
MusiQ 1 Handset A/B	ON/OFF	OFF	OFF	OFF
MusiQ 2 Handset A/B	ON/OFF	OFF	OFF	ON
MusiQ 3 Handset A/B	ON/OFF	OFF	ON	OFF
MusiQ 4 Handset A/B	ON/OFF	OFF	ON	ON
MusiQ 5 Handset A/B	ON/OFF	ON	OFF	OFF
MusiQ 6 Handset A/B	ON/OFF	ON	OFF	ON
MusiQ 7 Handset A/B	ON/OFF	ON	ON	OFF
MusiQ 8 Handset A/B	ON/OFF	ON	ON	ON

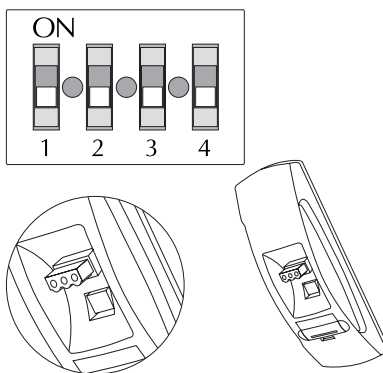

Note: Switch 1 at the rear of each handset determines which Zone is controlled, as follows:

- Handset for Zone A Switch 1 ON
- Handset for Zone B Switch 1 OFF

You can use as many RF handsets as you want to control each zone. If additional handsets are required, these can simply be set to the required address of the MusiQ RFS and Zone you want to control.

3.3 CONNECTING MULTIPLE MUSIQ USING SERIAL DATA LEAD AND AUDIO PASS THROUGH CABLE

If one or more slave MusiQ's are connected to a master, a serial data lead is used to relay the control code from from the master to the slave. The audio pass through cable is used to pass the audio signal from the master to the slave/s. Connect as per the following diagram:

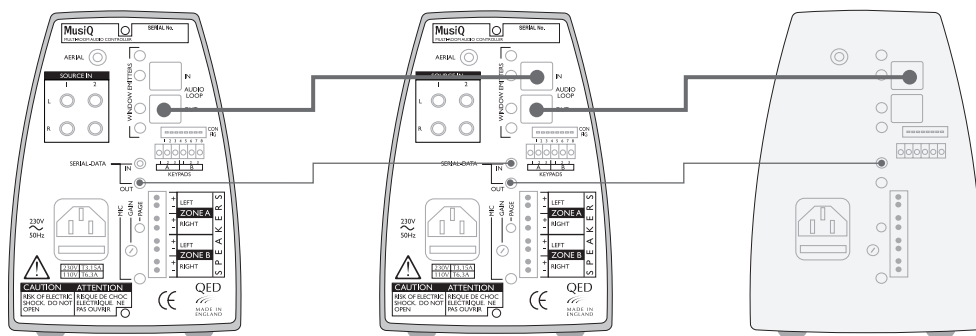

If required a 3rd MusiQ can be connected as shown

4 TROUBLESHOOTING

If you are having problems with the installation *DON'T PANIC*. It does not necessarily mean that the equipment is faulty. Please follow the following chart to help you diagnose faults and remedy them quickly.

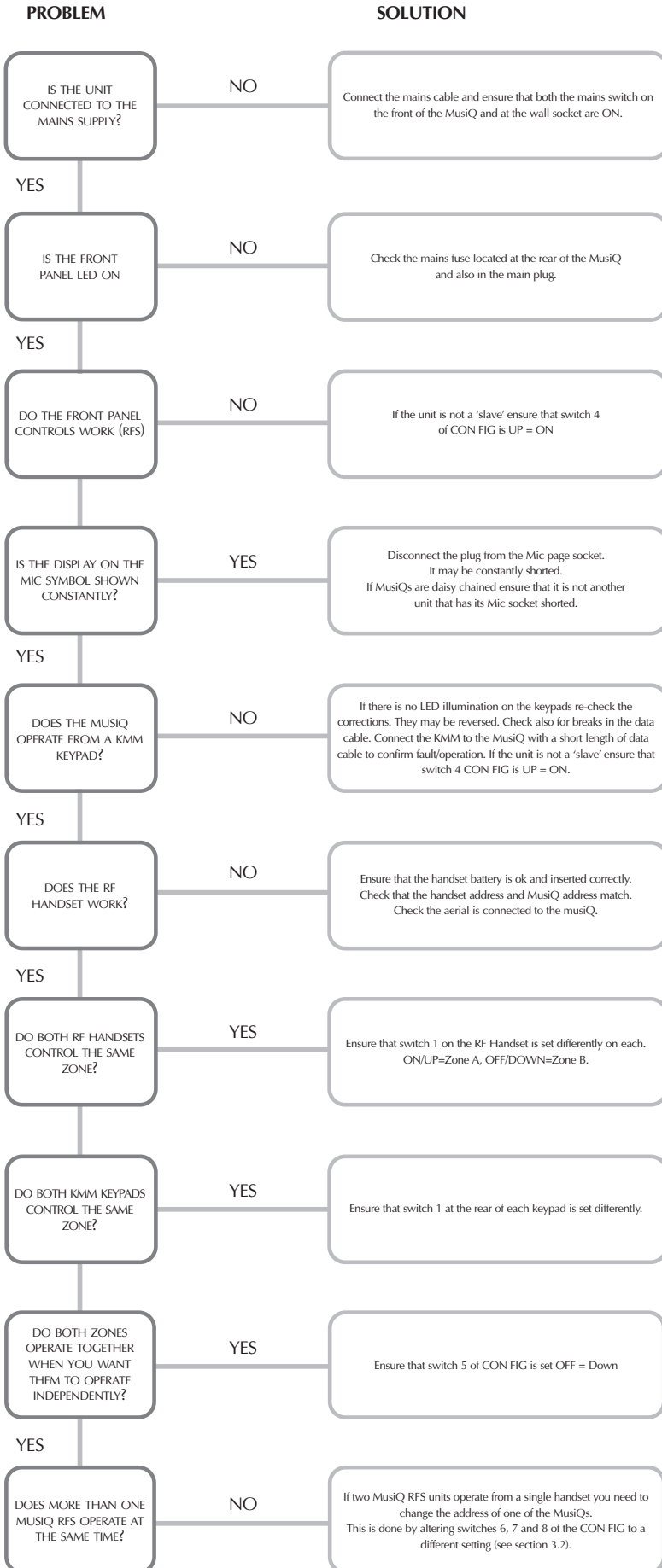

5 TECHNICAL SPECIFICATION

Power Output into 5 Ohms @ 1 kHz	22 W at 0.1%THD	One channel driven.
Power Output into 5 Ohms @ 1 kHz	20 W at 1.0%THD	Two channels driven.
Recommended Speaker Impedance:	4 - 16 Ohms	
Frequency Response:	20 Hz to 20 kHz \pm 0.5dB	
Frequency Response of Active EQ Sound Enhancement:	+2.75 dB @ 100 Hz relative to 0 dB at 1 kHz +0.55 dB @ 5.3 kHz relative to 0 dB at 1 kHz	
Distortion THD (measured into 5 Ohms)	1 kHz at 10 W <0.04%	One channel driven
Channel Separation:	>80 dB @1 kHz between Left & Right Channels. >90 dB @1 kHz between Source 1 & Source 2 Inputs.	
Input Sensitivity:	370 mV RMS into 100k Ohms for full output at maximum volume	

5.1 Microphone Input

Input Impedance:	680 Ohms <i>(suitable for microphones with a nominal impedance of 200-1k Ohms)</i>	
Gain Control Range:	45 dB	
Frequency Response:	40 Hz to 20 kHz \pm 0.8dB	

5.2 General

Weight:	3.5 kg	
Power Consumption:	120 W	
Battery <i>(MusiQ RF/RFS Handset only)</i>	Type MN21, GP23A or VR22 <i>(Available from all good photography shops)</i>	
Supported Brands	RC-5 - A Philips code set used by many other companies including Arcam, Linn and Marantz <i>Caution: Some manufacturers who claim to use this code set do not follow the correct protocol and therefore their equipment may not respond correctly, or at all.</i> Denon <i>Caution: MusiQ will operate tuners with direct preset selection only. Check with dealer first.</i> Pioneer, Sony, Yamaha	

6 OPERATION

6.1 MUSIQ FRONT PANEL CONTROLS (RFS MODELS)

Two columns of buttons on the front panels of the RFS models enable control of both Zones directly from the unit. The left hand buttons control the functions of Zone A and the right hand buttons control the functions of Zone B.

1. Pressing the Source 1 (tuner) or Source 2 (CD) button when the unit is in Standby will turn the zone ON and select the appropriate source. The volume will increase to a low listening level (see note below), and both the display and buttons will illuminate.

2. Pressing the Standby button will return the zone to standby. If both zones are active and one is switched into standby the other zone will remain ON. The display will remain active until both zones are in standby.

Note: When either Zone is returned to standby the Volume level is remembered, providing the unit is not switched OFF.

This means that the volume will return to the previous listening level when the zone is re-activated on subsequent occasions.

3. Pressing the Volume Up button will increase the listening level in the zone. The LCD volume bar graph display rises to indicate the level reached.

4. Pressing the Volume Down button will decrease the listening level in the zone. The LCD volume bar graph display falls to indicate the level reached.

6.1.1 ENTERING PARTY MODE

In normal operation both zones operate independently. Whether you are using a single MusiQ or multiple MusiQs it is sometimes desirable to have all zones selected to the same source, listening at the same volume level. To enter this mode of operation, if using a MusiQ RFS, ensure that both zones are in standby and press both Standby buttons (Zone A & B) together until the RED Standby LED turns AMBER. The unit is now in Party Mode and using either Zone A or Zone B controls will operate both zones. To exit party mode repeat the above procedure.



Note: The setting of CON FIG switch 5 (Party mode) determines whether Party mode is automatically ON or OFF when the unit is powered ON from the mains. This setting can always be overridden by the front panel controls on the RFS models. Once the unit is disconnected from the mains supply the CON FIG switch setting will override any alternative setting when mains power is re-applied.

If a slave is connected to a master RFS then enabling party mode from the front panel controls will also alter the mode on the slave units.

6.2 SOURCE CONTROL COMMANDS

The embedded key functions built into the MusiQ software enable easy operation of the main control functions for many tuner and CD source components (see Section 2.5.2). The available control functions are as follows:

- **Tuner Channel Skip** - If you wish to skip preset channels, simply depress the Source 1 key on the front panel of the RFS model (or on the remote RF handset/KMM keypad) until you hear the channel skip (approximately 1.5 seconds) and then release it. Only one preset is skipped; to skip further presets you must repeat the procedure for each preset.



Press for 1.5 seconds
Note: Once the first 8 presets are skipped the tuner will be returned to preset 1 on the next preset skip command.

- **CD Play** - To start the CD playing, depress the Source 2 key on the front panel of the RFS models (or on the remote handset/keypad) for approximately 3 seconds and then release it. After a few moments you should hear the CD playing.



Press for 3 seconds

- **CD Track Skip** – To skip tracks on a CD, hold down the Source 2 key on the front panel of the RFS models (or on the remote handset/keypad) for approximately 1.5 seconds and then release it. Repeat the procedure to skip further tracks.



Press for 1.5 seconds

- **CD Disc Skip** - If you are using a Multi Disc CD player and you wish to skip to the next disc, double click of the Source 2 key on the front panel of the CM or RFS models (or on the remote handset/keypad). The button should be depressed and released twice within a period of 0.5 seconds.



Press and Release within a period 0.5 seconds
Note: It is advisable to try all the above functions initially whilst you can see the source equipment operating. This will help you to obtain a feel for the button operation that issues each command.

6.3 USING A PROGRAMMABLE REMOTE CONTROL WITH KMM MODULES

It is possible to teach high quality learning handsets the 10 control commands. These commands are:

'ZONE A' Commands	'ZONE A' Commands
Select Source 1	Select Source 1
Select Source 2	Select Source 2
Standby	Standby
Volume Up	Volume Up
Volume Down	Volume Down

NOTE: The following IR learning handsets have been tested and work:

- Marantz RC-1200
- Marantz RC-2000
- Marantz RC-5000 (also Philips Pronto)
- ARCAM CR-9000

Procedure

- 1) Connect an IR window emitter to the MusiQ controller
- 2) Connect a KMM module to the Zone A of Zone B keypad input at the rear of the MusiQ.
- 3) Ensure that switch 1 of the KMM module is set to Zone A.
- 4) Position the IR window emitter a few inches away from the programmable handset IR receiver window.
- 5) There are 5 commands to learn for Zone control. (See note below)

Select Source 1	By pressing Button 1 on the KMM
Select Source 2	By pressing Button 2 on the KMM
Standby	By pressing Standby on the KMM
Volume Up	By pressing Volume Up on the KMM
Volume Down	By pressing Volume Down on the KMM

- 6) Ensure that switch 1 of the KMM module is set to Zone B.
- 7) Repeat the above steps 4 & 5 for Zone B operation

Note: Please refer to the programmable handset manual for specific instructions on how to learn codes.

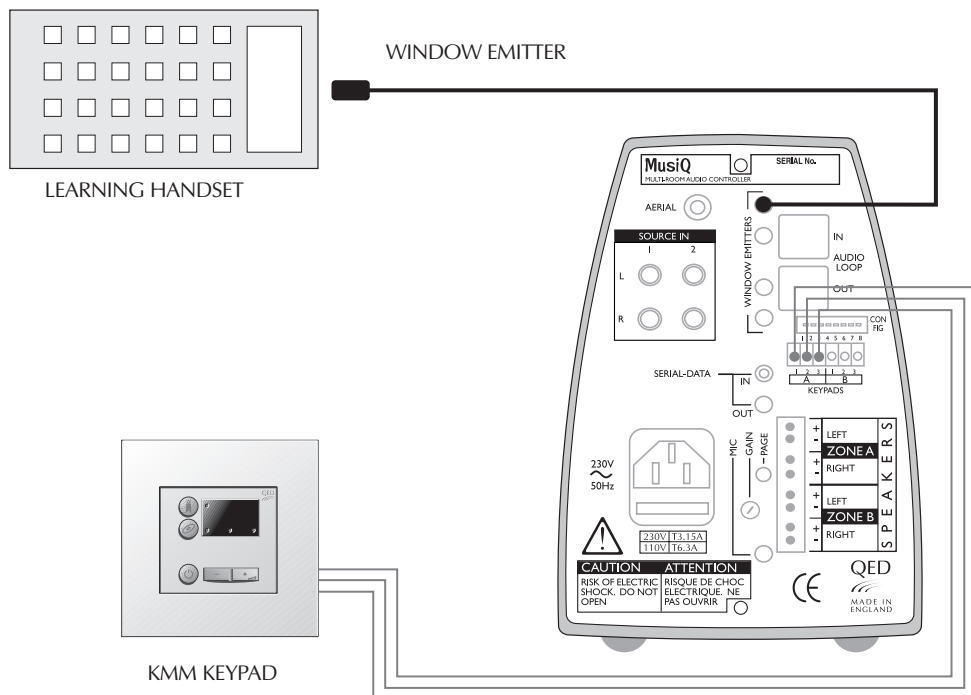

6.4 KEY FUNCTIONS



Infra-red receiver window

Switches zone off

Press once switches zone on and selects Tuner (Source 1)

Press and hold down will skip radio stations (8 stations loop)

Press and hold down for 3 seconds, will switchzone on and send play command* to C.D.player (Source 2)

Press and hold down for 1.5 seconds will skip to next track

Increase volume

Decrease volume

*Double press will skip the next disc.

Important Notice

These functions are only possible when using suitable products from supported brands (see specifications for list of brands).

The infra-red relay feature of the Docking handset can only be used when the handset is docked and the Docking Port suitably wired.

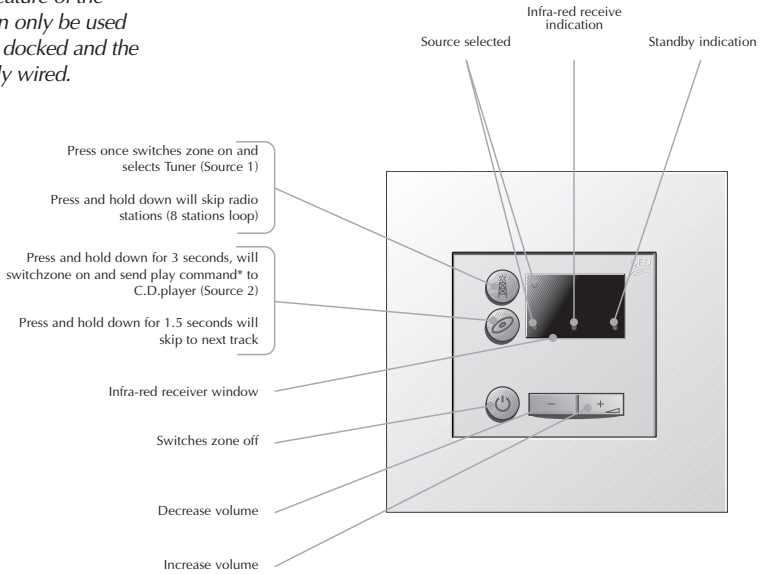

Press once switches zone on and selects Tuner (Source 1)

Press and hold down will skip radio stations (8 stations loop)

Press and hold down for 3 seconds, will switchzone on and send play command* to C.D.player (Source 2)

Press and hold down for 1.5 seconds will skip to next track

Infra-red receiver window

Switches zone off

Decrease volume

Increase volume

*Double press will skip the next disc.

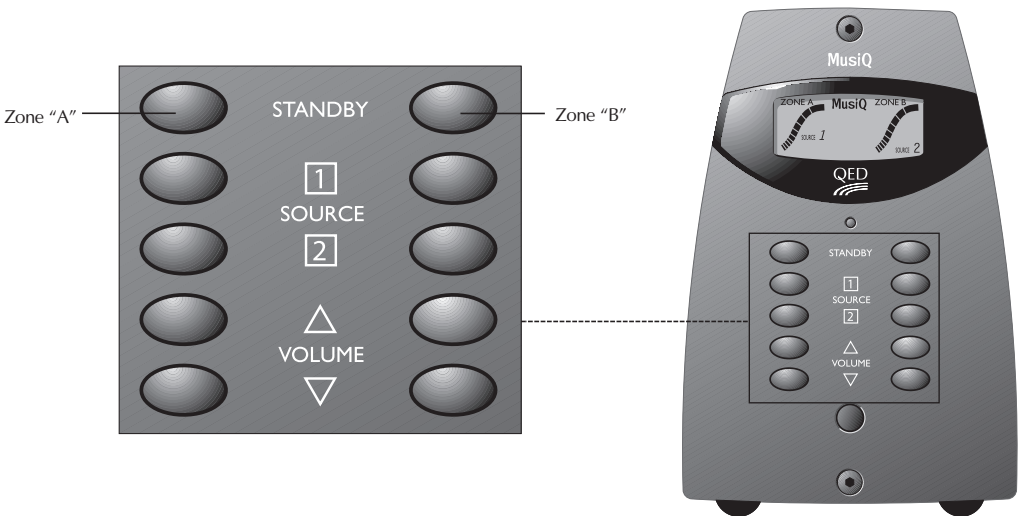

MusiQ RFS front panel controls

These enable both zones to be controlled directly from the unit. The functionality is the same as the RF handset detailed above. In addition, the LCD display conveys comprehensive information about the status of both zones.

6.5 STATUS DISPLAY RFS CONTROLLER ONLY

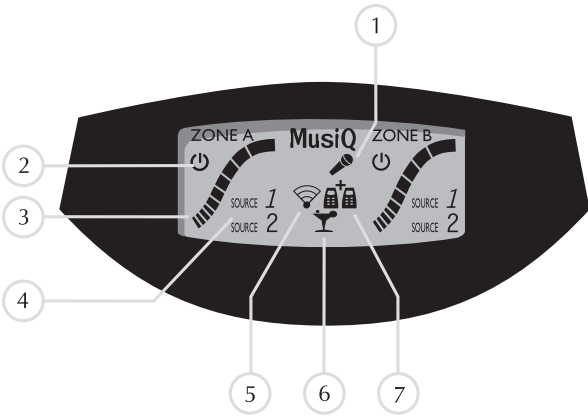

- 1) Microphone Paging Active
- 2) Zone in Standby Mode
- 3) Volume Level Indicator
- 4) Indicates Source Selected
- 5) Indicates a Command is being received from a KMM or RF Handset
- 6) Party Mode Activated
- 7) Serial Data Connection Active. This indicates data is being transferred between linked controllers

7 ADDITIONAL NOTES

LOOPING MUSIQ'S TOGETHER

Note 1: It is important to remember that when a unit is configured as a 'Slave' it will only respond to Serial Data Bus commands from the master unit. Front panel, RF handset and KMM commands are automatically disabled.

Note 2: For reliable Serial Bus communications it is important that the Audio Link lead is connected.

Note 3: The setting of the address switches has no effect on the operation of 'Slave' units.

Note 4: When looping units together you only need to connect IR window emitters to the last MusiQ in the chain.

Note 5: Do not try and connect sources via the source Input phono sockets and Audio Loop IN sockets at the same time.

Note 6: There must normally only be ONE master unit in a multiple MusiQ system. However, if a large number of MusiQ units are installed and you want to share common audio sources, there is a provision to have more than one Master unit.

The following diagram illustrates a typical example:

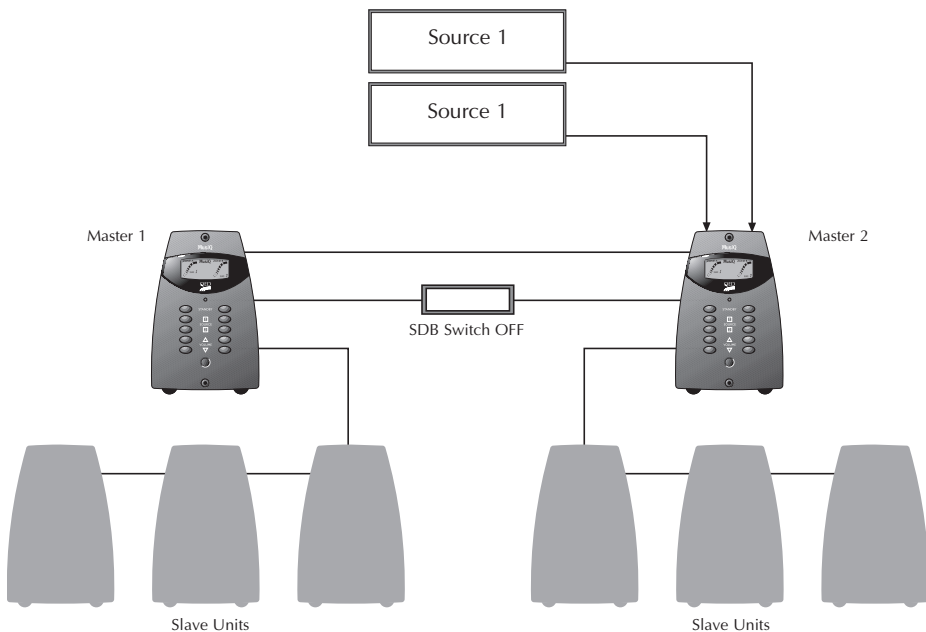

The SDB lead incorporates a switch which blocks both Masters controlling both sets of slave units. When configuring such a system ensure that the SDB switch is set to give independent control from each master unit.

MusiQ Mode d'emploi

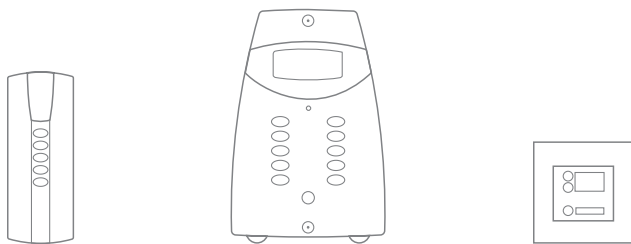

“Making Hi-Fi go places”
“La Hi-Fi en tous lieux”
“Musik für das ganze Haus”

QED MusiQ